

# TERMINAL BLOCK Connector

## Wago LED connectors

KLS2-L49

### Specification:

[Poles]:01P

[Contact resistance]: $\leq 20m\Omega$

[Insulation resistance]: $\geq 800M\Omega$

[Rated voltage]:250V AC DC

[Rated current]:2.0A AC DC

[Withstand voltage]:1500V AC/minute

[Temperature range]:-45°C ~ +125°C

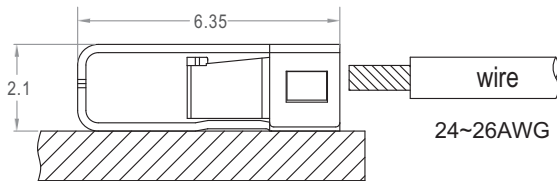
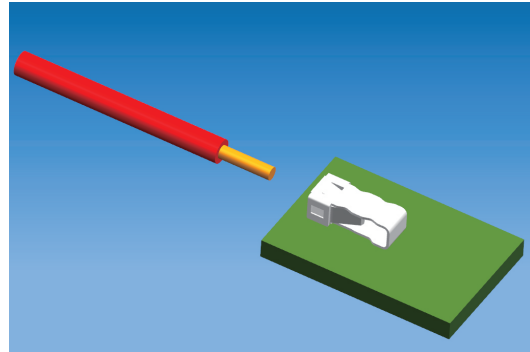

L49

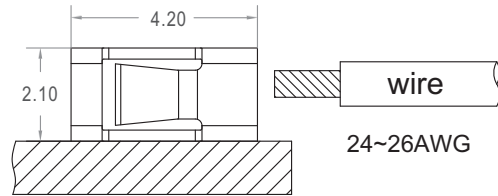

L49B

Assembly Layout

L49

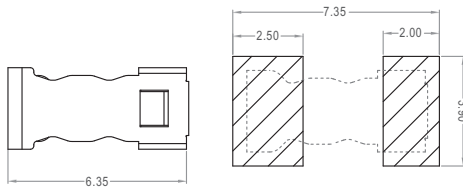

SMT type

L49B

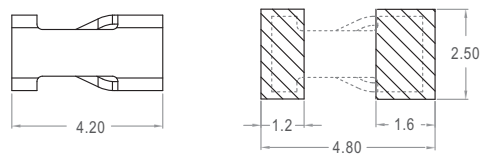

SMT type

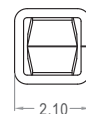
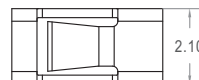
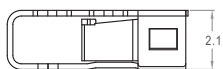

## ORDER INFORMATION

Product NO.: KLS2-L49

Pos. NO.

Series No.