



# PRODUCT SPECIFICATION

## 产品规格书

<b>Part Name / 产品型号</b>	Plastic Screw Protective Breather Vent Plug
<b>Voir P/N / 沃瑞编码</b>	VV-POVM16P3A-B30
<b>Customer / 客户型号</b>	
<b>Customer P/N / 客户料号</b>	
<b>Issue Date / 发布日期</b>	2015-6-3

<b>Checked / 审核</b>	<b>Prepared / 制作</b>	
<b>Li Zuo Jun</b>		
<b>Customer Approve / 客户核准</b>		
—		
—		

Components	
Body Material	PC
Membrane	e-PTFE
Sealing Ring	Silica

Parameter	
Airflow	120.4ml/min at $\Delta p=1.25\text{mbar}$
WIP	$>40\text{Kpa}$
Working Temperature	$-40^{\circ}\text{C} \sim +125^{\circ}\text{C}$
IP Rate	IP68



**SKU#:** VV-POVM16P3A-B30

Metric M16\*1.5mm PC screw vent plug reaches IP68 protective rate and conforms with RoHS certificate after test and inspection. With e-PTFE membrane inserted inside, it performs a very good resistance of UV and salt fog with a wide application.

**Application**

Applicable for industrial dust-collector and packing container, cosmetic and medicine industrial, household application, LED, communication equipment, solar equipment and automotive components. Not applicable for highly corrosive and acid-base environment.

**Benefit for Sealed Enclosure**

1. Vents in high airflow to balance the pressure and lower down tension for sealing stripe.
2. With the hydrophobic and oleophobic membrane inserted inside the anodized aluminum body, the vent plug becomes chemically inner and UV-resistant.
3. Press-fit installation and the silica sealing ring can both help in enhancing the airtightness.

**Practical Principle**

**Detailed Spec.**

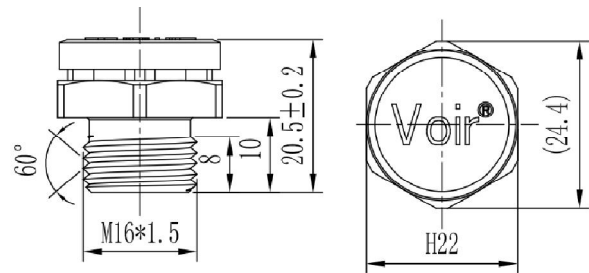
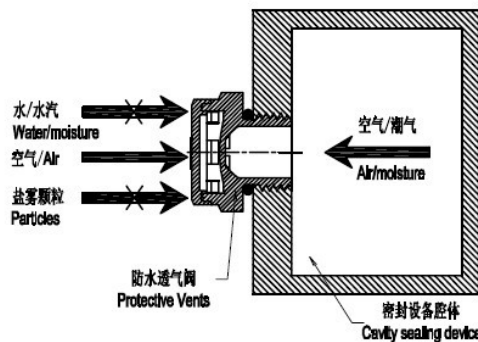

**Installation**

**Parameter**

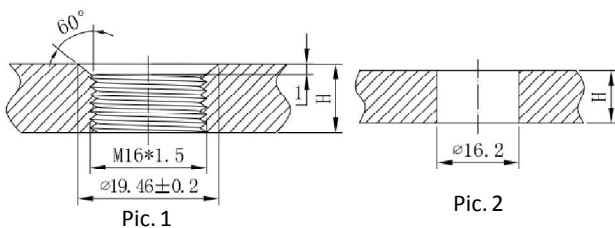

SKU#	Material	Diameter/mm	Airflow
VV-POVM16P3A-B30	PC	M16×1.5	120.4ml/min at $\Delta p=1.25\text{mbar}$ $>40\text{Kpa}$

**Installation Suggestion:**

- 1、H-Housing Thickness,  $\phi$ -Hole Diameter; Torsions $\leq 1.08\text{N/m}$
- 2、When  $H>3\text{mm}$ , it is suggested to drill a threaded hole at M16\*1.5mm. Chamfer is needed on the housing when using O-shape sealing ring, refer to Pic.1 for chamfer; Chamfer is not needed on the housing when using flat ring, refer to Pic.2 for chamfer.
- 3、When  $H\leq 3\text{mm}$ , it is suggested to drill a straight hole at  $\phi 16.2\text{mm}$  and lock with nut, refer to Pic.2. Chamfer is needed on the housing when using O-shape sealing ring, refer to Pic.1; Chamfer is not needed on the housing when using flat ring, refer to Pic.2

Customization: VoirTech's protective vents can be customized to match your products in spec., color, property and even provide specific solution. For more information, please contact us.